

- 1 **EN** Instruction Manual
- 2 **DE** Bedienungsanleitung
- 3 **FR** Manual d'instructions
- 4 **ES** Manual de instrucciones
- 5 **IT** Manuale di Istruzione
- 6 **PT** Manual de Instruções



# PULS

## DIMENSION

ZM11.SIDE, ZM12.SIDE  
ZM13.SIDE, ZM14.SIDE

### Bracket for Flat Mounting

This accessory is used to mount Dimension power supplies and other Dimension units sideways to reduce the installation depth. The two aluminum brackets and the black plastic slide must be removed from the units, to allow mounting of the zinc-plated steel bracket.

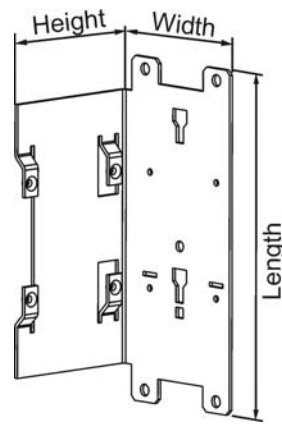
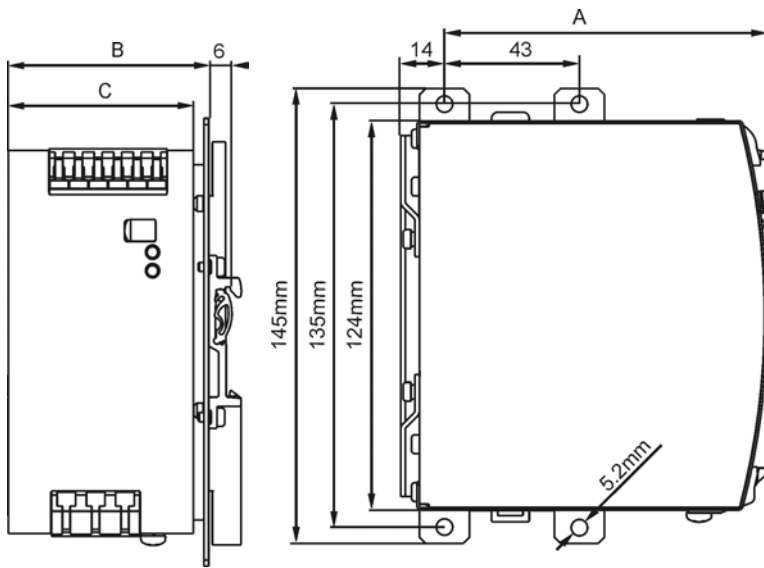

The drawings on the left show the bracket for DIN-rail mounting. The total installation depth is the B dimension plus 6mm plus the height of the DIN-Rail. In case the unit is panel mounted, the B dimension shows the required installation depth.

	Use Bracket	A	B	C	Length	Width	Height	Bracket Weight
QS3.XXX	ZM11.SIDE	89mm	38mm	32mm	145mm	65mm	37mm	140g
QS5.XXX	ZM12.SIDE	104mm	46mm	40mm	145mm	65mm	44mm	160g
QS10.XXX	ZM13.SIDE	104mm	66mm	60mm	145mm	65mm	63mm	180g
QT20.XXX	ZM14.SIDE	124mm	71mm	65mm	145mm	65mm	76mm	195g
YR2.DIODE	ZM11.SIDE	89mm	38mm	32mm	145mm	65mm	37mm	140g
UF20.XXX	ZM14.SIDE	89mm	79mm	64mm	145mm	65mm	76mm	195g
CS5.XXX	ZM11.SIDE	104mm	38mm	32mm	145mm	65mm	37mm	140g
CS10.XXX	ZM13.SIDE	104mm	66mm	60mm	145mm	65mm	63mm	180g

# Assembly and Mounting Instructions

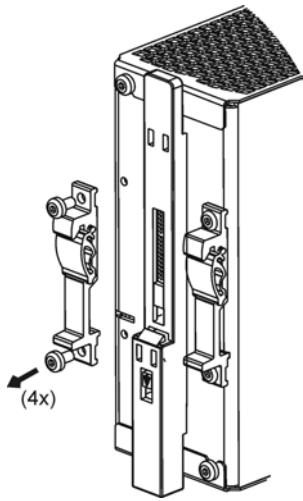

Detach the two aluminium brackets by removing the four screws with a Torx screwdriver (Torx 10).

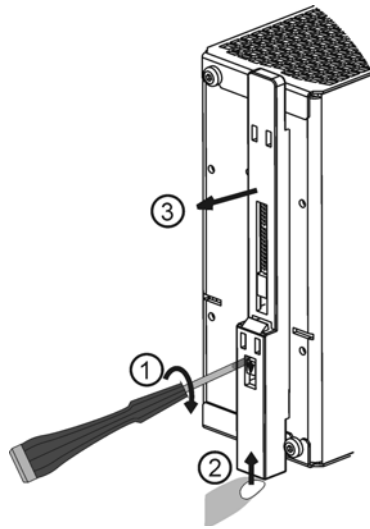

Remove the plastic lock mechanism by using a flat-blade screwdriver to move the lock downwards while at the same time push the plastic slider upwards. Detach the plastic slider.

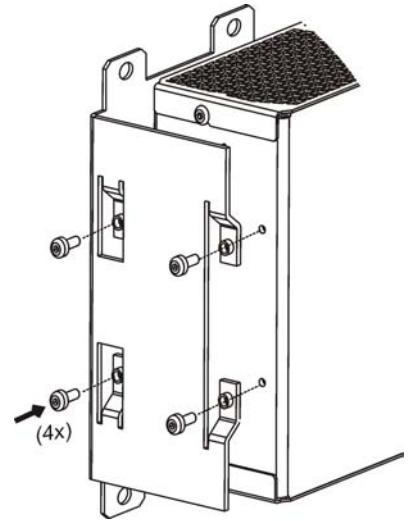

Mount the steel brackets with the same screws from the DIN-Rail brackets using caution not to over-tighten the screws! Recommended tightening torque is 0.6Nm. (5.3lb.in).

## Mounting Options

Preparation for DIN-rail mounting:

Assemble the two aluminium brackets and the plastic slider (detached from the unit before) onto the side mounting bracket. The additionally required screws are included in the shipping box.

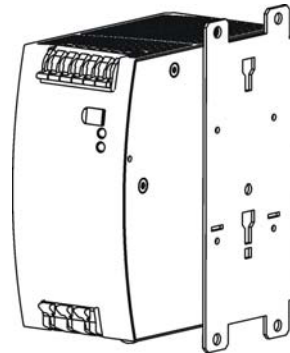

Mounting onto a flat wall

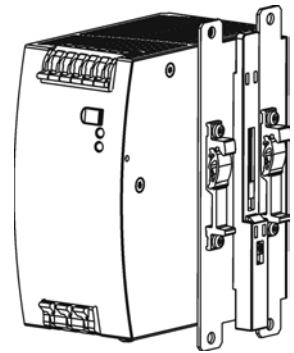

Mounting onto a DIN-rail

Germany	PULS in Munich	+49 89 9278 0	www.pulspower.com
China	PULS in Shanghai	+86 21 6432 7680	www.puls-power.cn
France	PULS in Limonest / Lyon	+33 478 668 941	www.pulspower.com/fr
North America	PULS in St. Charles / Chicago	+1 630 587 9780	www.puls-power.us
Austria	PULS in Rohrbach	+43 27 64 32 13	www.pulspower.com
Switzerland	PULS in Oberflachs / Aargau	+41 56 450 18 10	www.puls-power.ch
United Kingdom	PULS in Bedfordshire	+44 1525 72 00 99	www.puls.co.uk

Headquarters:  
PULS GmbH  
Arabellastrasse 15  
D-81925 Munich  
Germany

The information presented in this document is believed to be accurate and reliable and may change without notice

PU-200.010.80-10A