

This bracket is used to mount the unit onto a flat surface without utilizing a DIN - Rail.

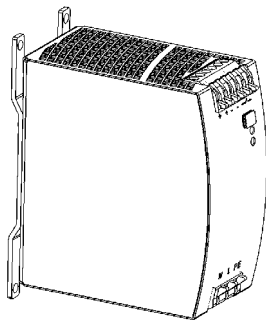
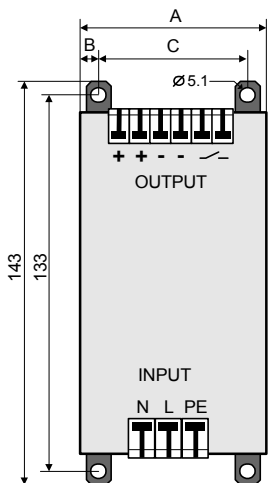
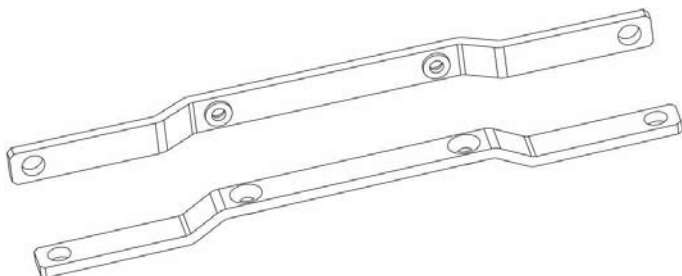

mm	A	B	C
QS3	32	4.8	22.5
QS5	40	5.3	29.5
QS10	60	5.8	48.5
QT20	65	6.3	40
YR2	32	4.8	22.5

Order Number:
ZM1.WALL

Quantity: 1 set

PULS

DE Wand Montage Adapter
 EN Wall Mounting Bracket
 FR **Kit de montage mural**
 ES Soporte para montaje en pared
 IT Staffa per montaggio a parete
 PT Suporte de montagem

PU-200.010.75-10A

www.flw.com/puls

PULS
 Distributed By **FLW** Inc,

(800) 576 -6308

Mounting Instructions:

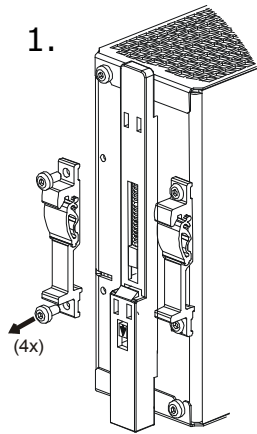

Detach the two aluminium brackets by removing the four screws with a Torx screwdriver (Torx 10).

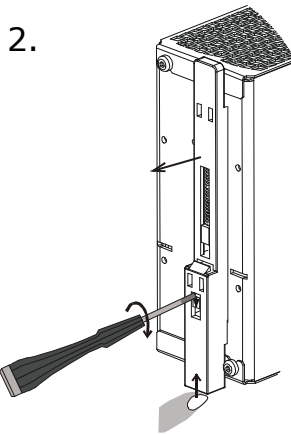

Remove the plastic lock mechanism by using a flat-blade screwdriver to move the lock downwards while at the same time push the plastic slider upwards. Detach the plastic slider.

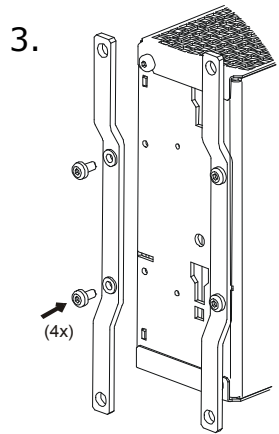

Mount the two steel brackets with the same screws from the DIN-Rail brackets using caution not to over-tighten the screws! Recommended tightening torque is 0.6Nm. (5.3lb.in).